

LOOKING FOR  
A NEW ADDRESS

☎ | Call: +91 90618 42905 (INDIA) 

☎ | Call: +971 55 515 5125 (UAE) 



[www.whitecloudhomes.com](http://www.whitecloudhomes.com)

  white\_cloud\_homes

The brochure is only for information and this does not constitute a legal offer/invitation to an offer. builder reserves the right for any alteration without notice



*Your  
happy moments  
begin here...*







White Cloude - Highlands is a brand new residential villa development located in Punalur, Kollam. This exclusive project comprises of 9 modern villas, all with amazing panoramic views towards Sahya Mountain. The design of Highlands villas is elegant yet modern at the same time. A true contrast of contemporary and classic materials together with a functional distribution brings a pleasant, elegant and harmonious cosy home.



## *The new land mark of punalur*

Punaloor town is only 10 minutes drive away and 15 minutes to Anchal town. Are you interested in Highlands villa? Contact us with all your questions, we are here to inform you and it would be a pleasure to visit the site and surrounding areas with you at any time.





WHITE CLOUD HOMES

## *About Highlands*

The transparency and the simplicity of shapes guarantee natural light accompanied by excellent ventilation. This exclusive development offers villas with a maximum accommodation up to 4 bedrooms and 4 bathrooms, but it is also possible to opt for a smaller unit of 3 bedrooms. Villas can vary in size from 1750 sqft to 2000 sqft and are located on plots of around 1acre. Prices vary between Rs 65lacs up to Rs 75lacs.



## *Villas like a resort*

All the qualities used in the villas will be of a high standard, only the best tiles, woods and carpentry in a luxury design. Once completed and if so desired our in-house interior designers will work together with you to find the best choices in furniture and finishes, feel free to ask for our recommendations. Arriving to your new home will be the moment you realise that you're living in the best peaceful area with an exclusive lifestyle!







Ground Floor : 1153 sq.ft

Ground Floor : 731 sq.ft





Ground Floor : 1150 sq.ft

Ground Floor : 691 sq.ft



Ground Floor : 1125 sq.ft

Ground Floor : 725 sq.ft





Ground Floor : 1150 sq.ft

Ground Floor : 725 sq.ft

TYPE D , TOTAL : 1875 SQ.FT

# HIGHLANDS

Villas at Punalur

## PROXIMITY

### MAJOR LANDMARKS

- Punalur - 3.7 Km
- Anchal - 9.4 Km
- Kottarakkara - 19 Km
- Adoor - 33.3 Km
- Pathanapuram - 16.8 Km
- Pathanamthitta - 43 Km
- Chadayamangalam - 19.2 Km
- Thenmala - 24.2 Km
- Kulathupuzha - 25.6 Km

### COLLEGE & SCHOLLS

- Sn College Punalur - 6 Km
- St Thomas College Anchal - 8.8 Km
- St Goretti School - 4.9 Km
- Gove: H S School Boys - 4.6 Km
- Fathima Public School - 5.5 Km

### HOSPITAL

- Poyanil Hospital - 5.8 Km
- Pranavam Hospital - 3.6 Km
- Gove: Taluk Hospital - 4.2 Km
- Aradhana Hospital - 3.3 Km







# HIGHLANDS

Villas at Punalur





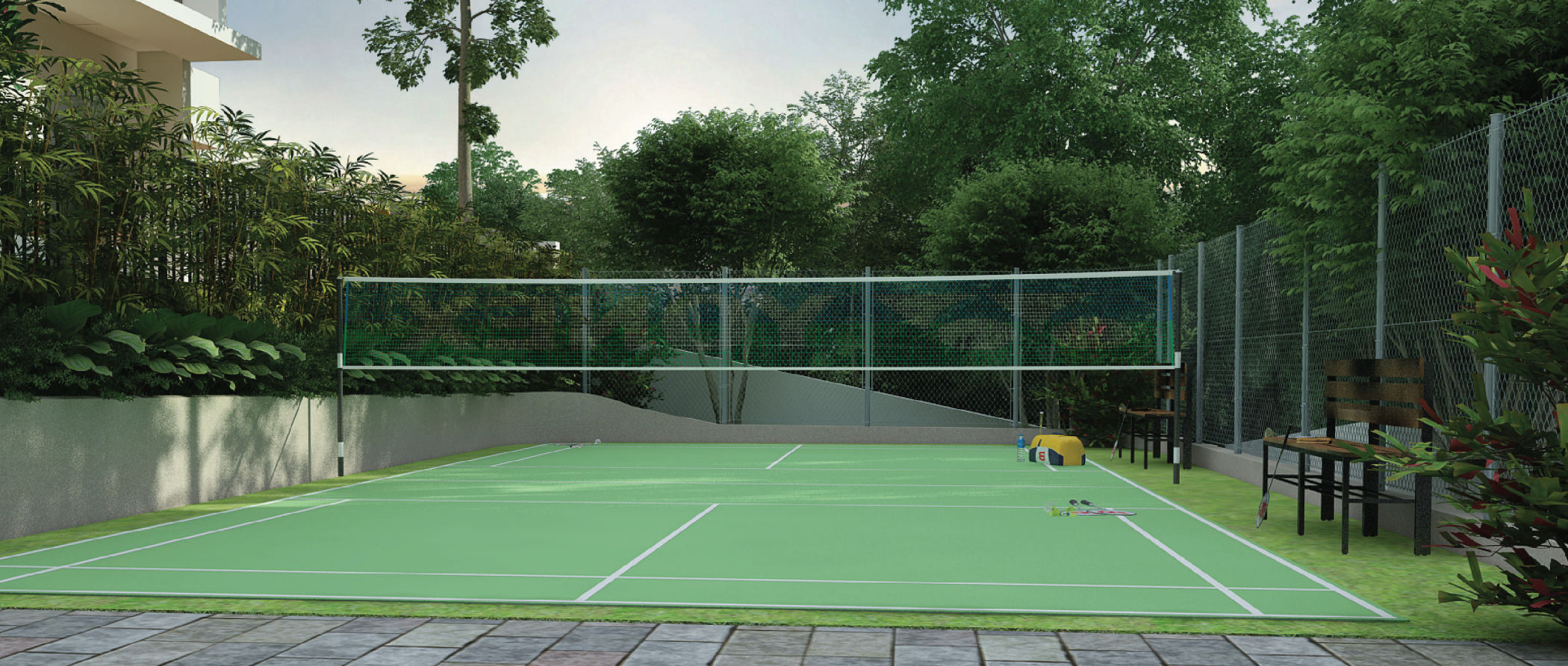

## AMENITIES

Outdoor Badminton court | Children's Play area | Visitors Car parking area.



## SPECIFICATION

### FOUNDATION:

Recommended by the Architect or Structural Engineer, Earthquake resistant.

### STRUCURE:

Strongly reinforced Cement Concrete blocks are used to frame our structures which ensure durability.

### FLOORINGS:

vitrified tiles for entire area except bathroom.

### DOORS AND WINDOWS

Entrance door in teakwood. Elegant hard core doors for bedrooms, kitchen and toilets. UPVC French windows for dining and first floor balcony. Hard wood windows and ventilators.

### ELECTRICAL

Concealed conduit wiring with copper conductor, adequate light and fan points, 6/16 amps socket points etc. controlled by ELCB and MCBs with independent KSEB meters. Provision for AC in all bedrooms.

### TOILET

Toilet walls with vitrified tiles/superior quality ceramic tiles upto false ceiling. Toilet floor with vitrified tile/superior quality ceramic tiles. Concealed piping and premium quality CP fittings (Jaquar vignette range or equivalent). Hot and cold water taps with shower in all toilets. Hot water provision for kitchen sink, work are...

Water will be available around the clock through water main line connection and individual water well.